

J A S



20 Spring Street East Port Melbourne VIC

2 🏠 1 📄

View : <https://www.jasstephens.com.au/8197642>

Flooded with natural light enjoying a north facing rear aspect, this enchanting single-level freestanding Victorian home promises effortless living in a prime location near Bay Street's lively retail and dining hub. Just a short stroll to the beach, Gasworks Park, and Albert Park Village, it perfectly balances urban vibrancy with a serene garden backdrop, offering a peaceful inner-city base in the midst of all the action.



Nathan Budge-Welsh
0437003431



Damien Welch
0478135941

Beyond a white picket fence the property comprises of;

- Open-plan living zone with twin French doors connecting to the north-east terrace
- Private terrace ideally suited to indoor and outdoor entertaining
- A well-appointed kitchen with stone benchtops
- The living room features high raked ceilings emphasising light and space

20 Spring Street East, Port Melbourne

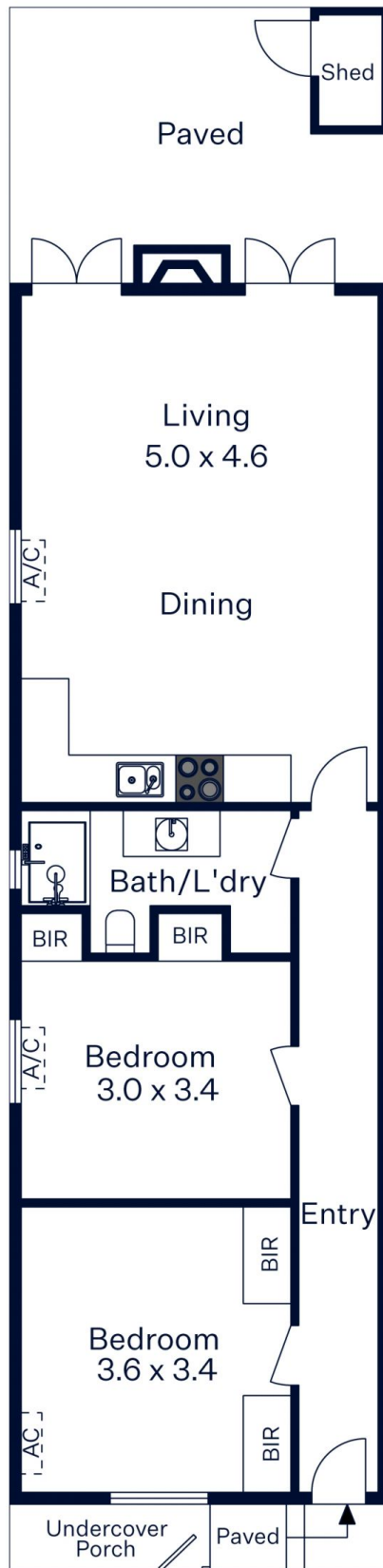

Disclaimer: Information provided is believed to be accurate as at the date of printing, no responsibility is taken for any errors or omissions. It is your responsibility to obtain independent, professional advice. Personal information collected from you is for security purposes and to contact you should the property sell prior to auction. We may use this information to provide you with other real estate services including referrals to authorised financial services' providers. Visit our website at www.marshallwhite.com.au for our privacy policy.

Not to scale