

# J A S



## Unit 7/2 Burleigh Street Spotswood VIC

3 

### MODERN OPEN SPAN GROUND LEVEL WAREHOUSE

This is your opportunity to secure a 410 sqm (approx) modern warehouse premises in an unbeatable prime location of Spotswood. Direct access to Westgate Freeway, providing uninterrupted travel to the airport, docks and city precinct. This warehouse is perfectly suited for all warehousing/retail/wholesale distribution or tradesman centre headquarters. The modern property encompassing a single span ground level warehouse with office and toilet/shower facilities.. Perfectly suited for an importer, small manufacturer, multiple business/retail applications, storage, or small showroom, just to name a few (STCA).

Property Features Include:

- Electric high container lift roller door and 9m roof

**Price** : Contact Agent  
**Building Size** : 410 sqm  
**Land Size** : 410 sqm  
**View** : <https://www.jasstephens.com.au/8050766>



**Chris Worthy**  
0456809247

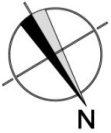
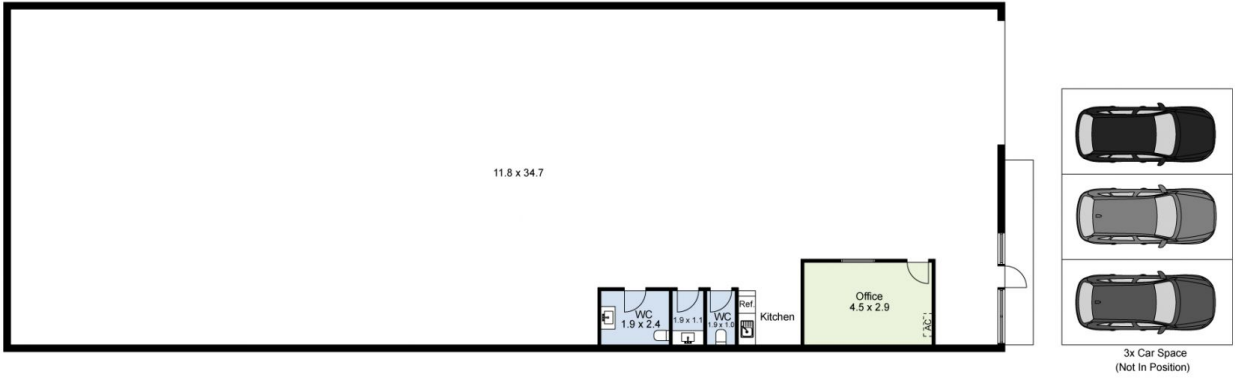

## Total Internal Measurement 409 Sqm.

Measurements are indicative and in meters. Exterior elements are not in exact position.  
Interested parties should confirm details at their own discretion